

## Service Data

### Pressure Control Valves

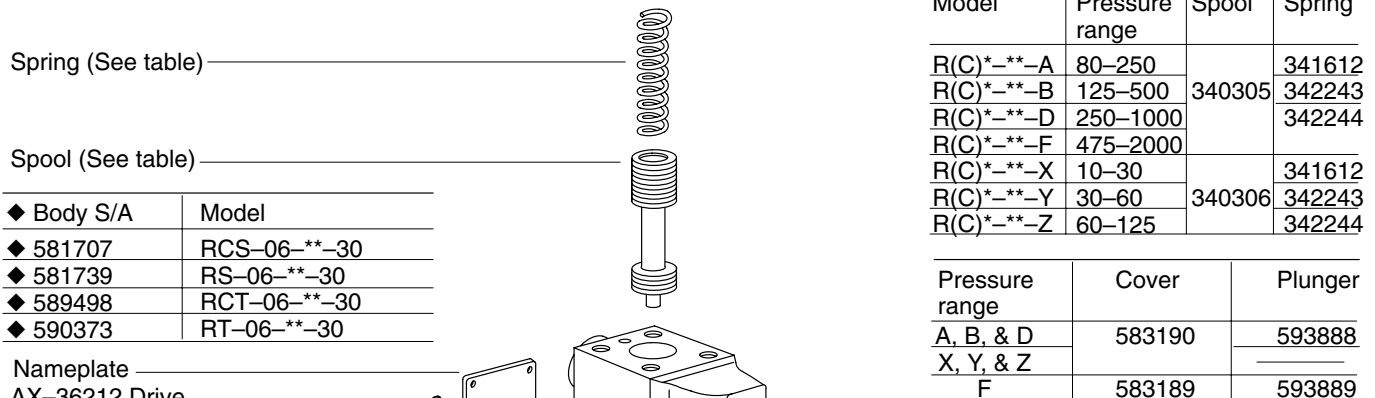

**R(C)T-06-\*\*-30**  
**R(C)S-06-\*\*-30**

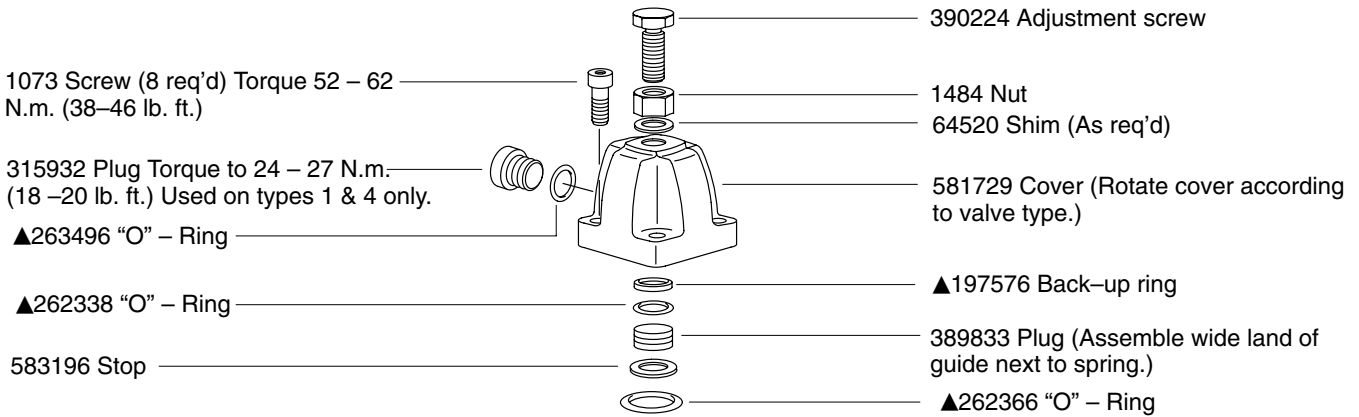

◆ Body S/A	Model
◆ 581707	RCS-06-**-30
◆ 581739	RS-06-**-30
◆ 589498	RCT-06-**-30
◆ 590373	RT-06-**-30

Model	Pressure range	Spool	Spring
R(C)*-**-A	80-250		341612
R(C)*-**-B	125-500	340305	342243
R(C)*-**-D	250-1000		342244
R(C)*-**-F	475-2000		
R(C)*-**-X	10-30		341612
R(C)*-**-Y	30-60	340306	342243
R(C)*-**-Z	60-125		342244

Pressure range	Cover	Plunger
A, B, & D	583190	593888
X, Y, & Z		
F	583189	593889

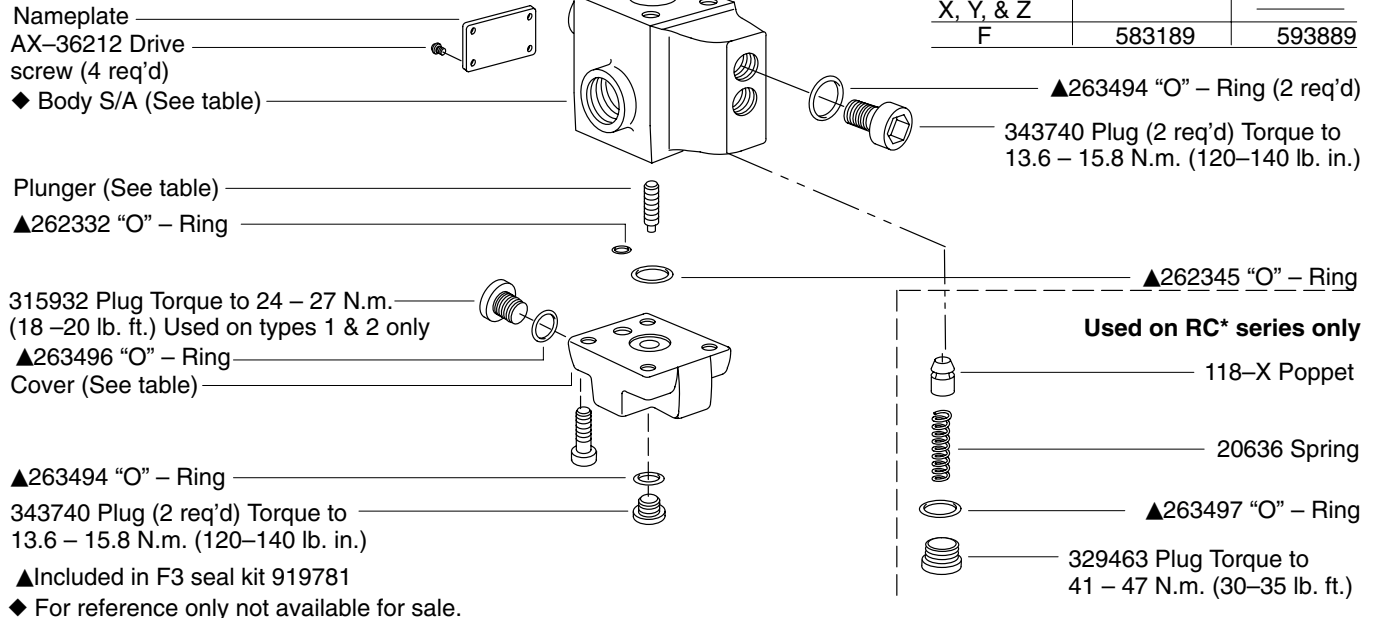

# Model Code

**(F3) - R (C) \* - 06 - \*\* - 30**

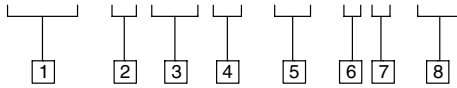

**1 Special seals**  
(Omit on STD. models.)

**2 Pressure control valve**

**3 Check valve option**  
**C** – With integral check valve  
 (Reverse free flow)  
**Omit** – No check valve

**4 Mounting**

**S** – 1.0625–12 UNF–2B thread  
**T** – 3/4" NPTF thread

**5 Connection size**

**06** – 3/4" Pipe thread

**6 Pressure range**

**A** – 80 – 250 PSI  
**B** – 125 – 500 PSI  
**D** – 250 – 1000 PSI  
**F** – 475 – 2000 PSI  
**X** – 10 – 30 PSI  
**Y** – 30 – 60 PSI  
**Z** – 60 – 125 PSI

**7 Valve types**

(Inset views at bottom of page show cover positions for the (4) valve types.)

**8 Design**

Typical model number  
 RCT-06-D4-30

**Note**

Assemble covers as shown to obtain valve action desired.

**Type 1**

RT series – Back pressure valve.  
 RCT series – Counterbalance valve.  
 Directly controlled internal drain

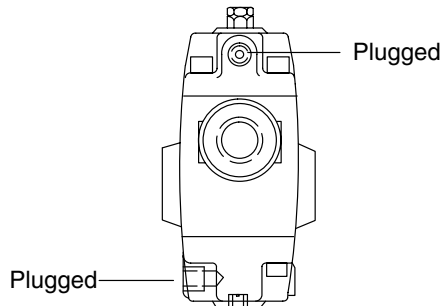

**Note**

Assemble covers as shown to obtain valve action desired.

**Type 2**

RT or RCT series – Sequence valves.  
 Directly controlled external drain

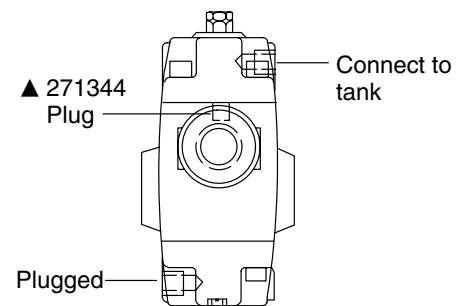

**Type 3**

RT or RCT series – Sequence valves.  
 Remotely controlled external drain

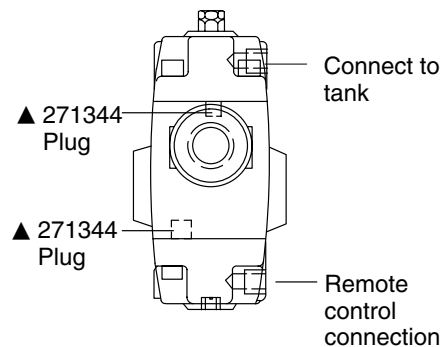

**Type 4**

RT series – Unloading valve.  
 RCT series – Counterbalance valve.  
 Remotely controlled internal drain

